

OCULAR



Ocular LTE Plus

Installation Guide

ocularcharging.com.au
sales@ocularcharging.com.au
1300 912 650

Accessories of Tethered Model

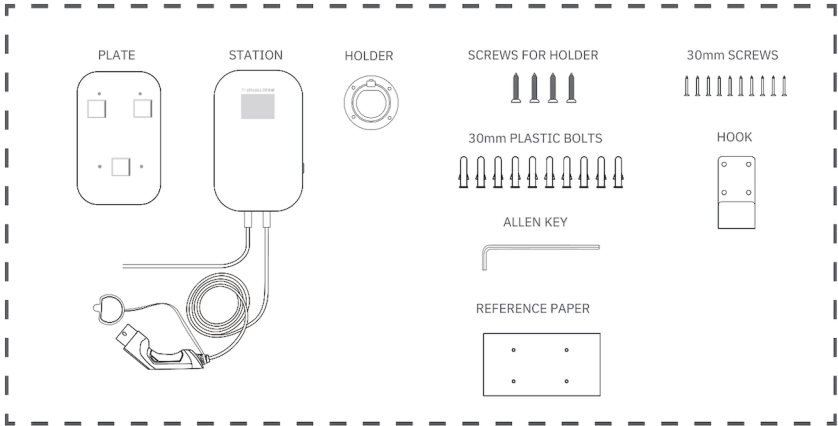

Station Overview

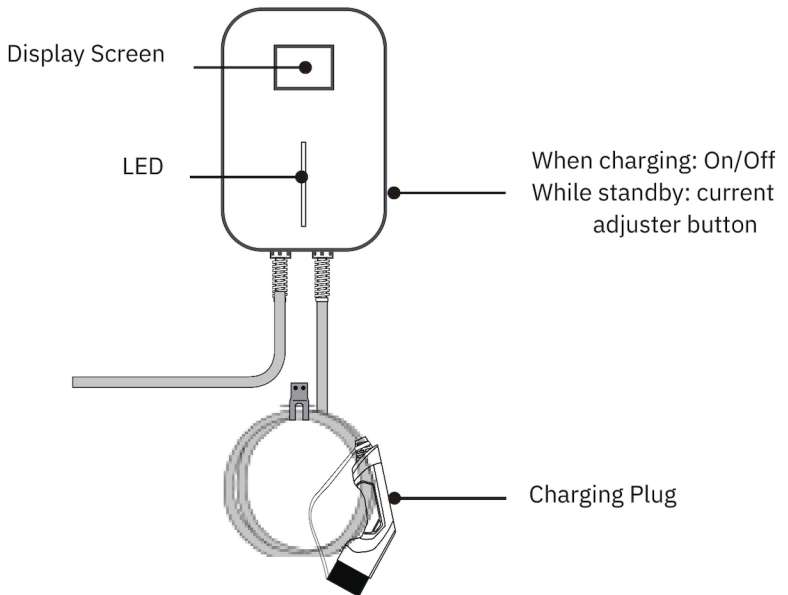

Level 2 EV Charging Station

Phase Mode: Single Phase
 Installation Method: Wall/Stand
 Certificate: CE, TUV, RCM
 IP Rating: IP66

Rated Voltage: 230VAC +/- 10%

Rated Current: 32A

Maximum Power: 7.2 kW

Ambient External Temp: -25°C ~ +55°C

Enclosure Material: ABS + PC alloy

Warranty: 2 years

Phase Mode: Three Phase

Installation Method: Wall/Stand

Certificate: CE, TUV, RCM

IP Rating: IP66

Rated Voltage: 400VAC +/- 10%

Rated Current: 32A

Maximum Power: 22 kW

Ambient External Temp: -25°C ~ +55°C

Enclosure Material: ABS + PC alloy

Warranty: 2 years

Instruction for Use

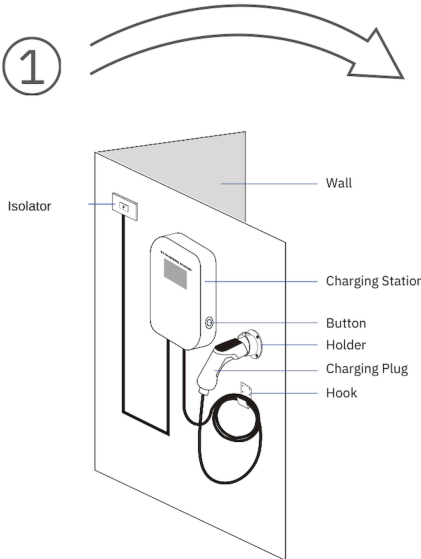

②

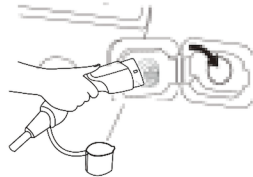

Connect the EV and the wallbox with the EV charging cable

Make sure the wallbox is connected to power

- ◆ Hang the cable on the hook when it is not in use

Installation Guide

1

REFERENCE PAPER
of installing screw hole size

Wall

Drill the holes
according to the
REFERENCE PAPER

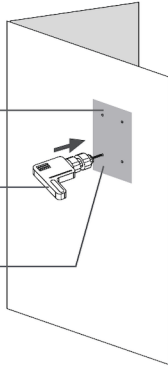

2

Hammer the
30mm PLASTIC BOLTS
into the holes

Take down the
REFERENCE PAPER
from the wall later

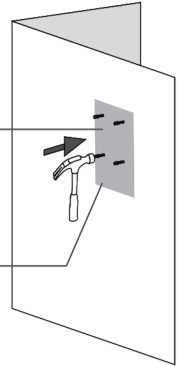

3

Fix the PLATE
with 30mm SCREWS
on the wall

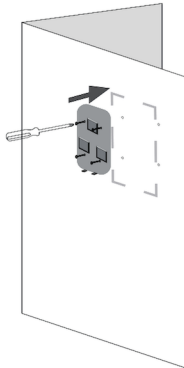

4

Embed STATION into
PLATE on the wall
Use Connector Clip to
connect base plate to
charger

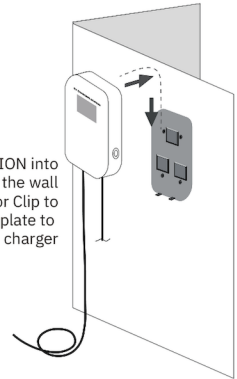

5

This is the final completion pic,
you can put the HOOK
and HOLDER
anywhere you need

The cable can
be hung on the
HOOK and HOLDER

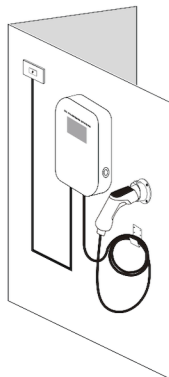



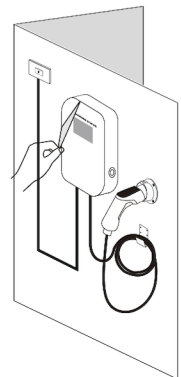

6

Tear off the protector

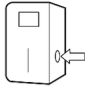

Note: Power cables must be crimped with suitable ferrules otherwise product warranty will be voided

Illustration of Screen and LED

<p>EV AC Charger</p> <p>Start-up screen (the version no. is for reference only)</p>	<p>EV Charger</p>  <p>Connect the Charging Connector 22.8°C</p> <p>Wait for inserting the plug</p>	<p>EV Charger</p>  <p>Press The Button or use the app 22.8°C</p> <p>Wait for identification</p>									
<p>EV Charger</p>  <p>22.8°C</p> <p>Wait for the car to be ready</p>	<p>EV Charger</p> <p>0.0 KW</p> <table border="0"> <tr><td>■</td><td>L1:220V</td><td>0.00A</td></tr> <tr><td>■</td><td>L2:220V</td><td>0.08A</td></tr> <tr><td>■</td><td>L3:220V</td><td>0.08A</td></tr> </table>  <p>00:00:06 0.00kwh 23.7°C</p> <p>During charging process</p>	■	L1:220V	0.00A	■	L2:220V	0.08A	■	L3:220V	0.08A	<p>EV Charger</p>  <p>Disconnect the Charging Connector</p> <p>00:10:00 0.00kwh 22.8°C</p> <p>Stop charging and wait for pulling out the plug</p>
■	L1:220V	0.00A									
■	L2:220V	0.08A									
■	L3:220V	0.08A									

EV Charger

1. 0.0 KW

2. L1:220V 0.00A
L2:220V 0.08A
L3:220V 0.08A

3. 00:00:06 0.00kwh

4. 23.7°C

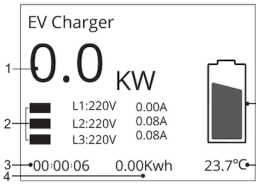

1. Real-time power
2. Three Live Wire data
3. Charging Time
4. Power Consumption
5. Charging Icon
6. PCB Temperature

EV Charger



Possible fault warning

Short Current

29.4 °C

1. Emergency stop
2. Over Current
3. Over Temperature
4. Leakage protection
5. Short Current

	IDLE	CONNECTED	CHARGING	FINISHED	ERROR
Instruction of LED Status	OFF	Continuous light	Rolling	Continuous light	Red flashing

Note:

The Ocular LTE plus will automatically restart when minor problems occur.

For serious failures, the system cannot automatically recover. In order to remind user of this failure, the system will automatically countdown 10 seconds to restart.

Safety Warning

- ▲ Regularly check whether the charging station has visible damage.
- ▲ Make sure that all safety facilities are available at all times and are tested regularly to ensure they can operate normally. Visit ocularcharging.com.au for a yearly maintenance check according to Australian standards.
- ▲ If a ground fault occurs, it must be assumed that the cable carries voltage. Please confirm that there's no high-voltage power in the system before inspecting the charging station.
- ▲ Persons who install and use charging stations must obey the principles and regulations mentioned to ensure personal and equipment safety.
- ▲ Before powering on the device, please confirm that the device is properly grounded to avoid unnecessary accidents.
- ▲ All tools' unnecessarily exposed metal parts should be insulated to prevent them from touching the metal frame to avoid short circuits.
- ▲ Do not modify, retrofit, or change any part by yourself under any circumstances.
- ▲ To ensure the service life and stable operation of the charging station, the operating environment should be kept clean as possible with a relatively stable temperature and humidity. The charging station must not be used in a flammable environment or environments with volatile gas.
- ▲ Be sure to confirm that the input voltage, frequency, circuit breakers and other conditions of the device meet the specifications before the device is powered on

Maintenance

Ocular LTE Plus is only recommended for use in residential applications and use outside of this area (i.e. for commercial application) is outside of warranty.

In order to ensure the normal service life of the charging station and reduce risk, maintenance must be performed every 12 months. The maintenance and installation of the equipment must be completed by a licensed electrician. Visit ocularcharging.com.au to book your service.

The product should be placed at an ambient temperature of -25C~+55C in relative humidity of no more than 95%. The air should not contain acids, alkalis, or other corrosive and explosive gases.

Ocular Charging Stations are subject to stringent quality inspections. From the day of purchase, any problem quality can be reflected to the dealer within two years. Any direct damage or malfunction caused by neglect, incorrect use, installation, usage, repair by the users or natural damage are not covered by the warranty.

MANUFACTURER
Ocular Charging

ocularcharging.com.au
sales@ocularcharging.com.au



OCULAR

CHARGE WITH VISION

MANUFACTURER
Ocular Charging

ocularcharging.com.au

sales@ocularcharging.com.au

OCULAR

CHARGE WITH VISION